

\$430,000 - 3953 W Park Creek Dr, Meridian

MLS® #98964400

\$430,000

3 Bedroom, 2.00 Bathroom, 1,502 sqft
Residential on 0.20 Acres

Rods Parkside C, Meridian, ID

Welcome Home to this clean, well maintained and updated single-level home w/mature landscaping located in the coveted Parkside neighborhood. The open concept great room has vaulted ceilings w/lots of natural light & a gas fireplace. The kitchen features a breakfast bar & pantry. The master suite offers separated bath-tub/shower, dual vanities, & two walk-in closets. The private backyard has lots of shade & is perfect for relaxing. Water heater & HVAC are only 5 years old. New updated flooring throughout! Over-sized driveway provides for RV Parking. Walking distance to Fuller City Park and Chaparral Elementary in the neighborhood. Great shopping and freeway access.

Built in 1994

Essential Information

MLS® #	98964400
Price Per SQFT	\$286
Bedrooms	3
Bathrooms	2.00
Square Footage	1,502
Acres	0.20
Year Built	1994
Type	Residential
Sub-Type	Single Family Residence
Status	New

Community Information

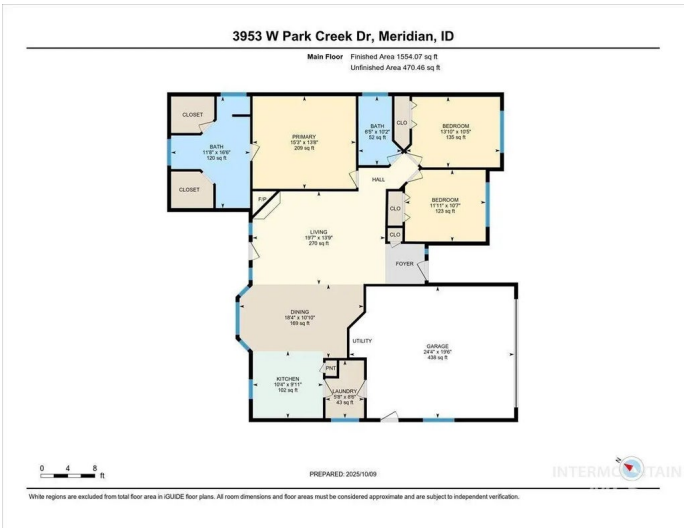

Address	3953 W Park Creek Dr
Area	Meridian NW - 1030
Subdivision	Rods Parkside C
City	Meridian
County	Ada
State	ID
Zip Code	83642

Amenities

Utilities	Sewer Connected, Cable Connected, Broadband Internet
Parking Spaces	2
Parking	Attached, Tandem, RV Access/Parking, Finished Driveway
# of Garages	2
RV/Boat Parking	Yes
Golf Course	N
Virtual Tour	https://unbranded.youriguide.com/oymq9_3953_w_park_creek_dr_meridian_id/

Interior

Interior Features	Bath-Master, Bed-Master Main Level, Great Room, Double Vanity, Walk-In Closet(s), Breakfast Bar, Pantry, Laminate Counters
Appliances	Gas Water Heater, Tank Water Heater, Dishwasher, Disposal, Microwave, Oven/Range Freestanding
Heating	Forced Air, Natural Gas
Cooling	Central Air
Fireplace	Yes
Fireplaces	One, Gas
Stories	One
Primary On Main	Yes

Exterior

Lot Description	Standard Lot 6000-9999 SF, Garden, R.V. Parking, Sidewalks, Auto Sprinkler System, Drip Sprinkler System, Full Sprinkler System
Roof	Architectural Style
Foundation	Crawl Space

School Information

District	West Ada School District
Elementary	Chaparral

Middle	Meridian Middle
High	Meridian

Additional Information

Date Listed	October 10th, 2025
Days on Market	1
Zoning	R-4
HOA Fees	\$125
HOA Fees Freq.	Annually
Property Taxes	\$1,247
Tax Year	2024
Office	Evolv Brokerage
Contact Info	frontdesk@evolvbrokerage.com

Listing Details

Listing Office	Evolv Brokerage
----------------	-----------------



IDX information is provided exclusively for consumers' personal, non-commercial use, and may not be used for any purpose other than to identify prospective properties consumers may be interested in purchasing. IMLS does not assume any liability for missing or inaccurate data. Information provided by IMLS is deemed reliable but not guaranteed.

Listing information last updated on October 11th, 2025 at 5:03pm MDT