

\$659,000 - 6671 S Zenith Ave., Meridian

MLS® #98964228

\$659,000

4 Bedroom, 3.00 Bathroom, 2,674 sqft
Residential on 0.15 Acres

Pinnacle, Meridian, ID

This beautiful home is in one of the best spots in South Meridian—close to everything! Enjoy outdoor concerts, a farmers market, bike rides, a community pool and clubhouse, parks, a K-12 charter school in the neighborhood, and just a short walk from the 27-acre Discovery Park. Inside, the main level features three bedrooms, including a primary suite with a walk-in closet that connects directly to the laundry room for extra convenience. The kitchen boasts beautiful finishes, double ovens, a built-in microwave, and a walk-in pantry. The living room is bright and inviting, with a gas fireplace and tall ceilings. Upstairs, you’ll find a large bonus room, plus another bedroom and full bathroom—perfect for guests or a private suite. The backyard offers stunning views of the Owyhee Mountains with no neighbors behind. Thoughtful upgrades include year-round holiday lights, an EV charger in the garage, a whole-house humidifier, air scrubber, tankless water heater, electric shades, and shutters on select windows.

Built in 2022

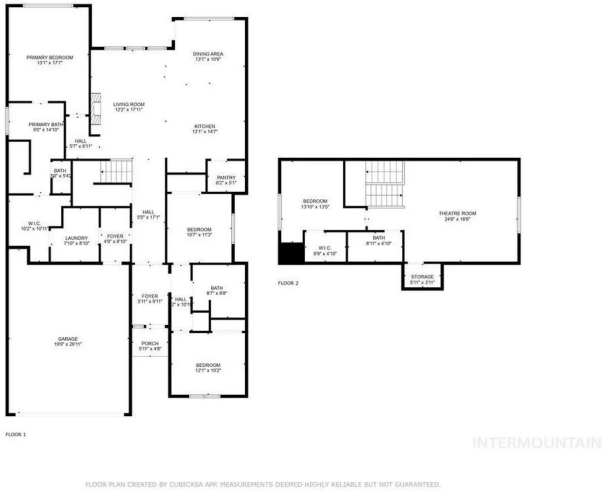

Essential Information

MLS® #	98964228
Price Per SQFT	\$246
Bedrooms	4
Bathrooms	3.00

Square Footage	2,674
Acres	0.15
Year Built	2022
Type	Residential
Sub-Type	Single Family Residence
Status	Active

Community Information

Address	6671 S Zenith Ave.
Area	Meridian SE - 1000
Subdivision	Pinnacle
City	Meridian
County	Ada
State	ID
Zip Code	83642
Builder	Alturas Homes

Amenities

Utilities	Sewer Connected
Parking Spaces	2
Parking	Attached
# of Garages	2
Has Pool	Yes
Pool	Community
View	Yes
Golf Course	N

Interior

Interior Features	Bed-Master Main Level, Split Bedroom, Rec/Bonus, Central Vacuum Plumbed, Walk-In Closet(s), Walk In Shower, Pantry, Kitchen Island, Quartz Counters
Appliances	Tankless Water Heater, Dishwasher, Microwave, Oven/Range Built-In, Gas Range
Heating	Forced Air, Natural Gas
Cooling	Central Air
Fireplace	Yes
Fireplaces	Gas
Stories	Two
Primary On Main	Yes

Exterior

Lot Description	Standard Lot 6000-9999 SF, Irrigation Available, Sidewalks, Views, Auto Sprinkler System, Pressurized Irrigation Sprinkler System, Irrigation Sprinkler System
Roof	Composition
Foundation	Crawl Space

School Information

District	West Ada School District
Elementary	Mary McPherson
Middle	Victory
High	Mountain View

Additional Information

Date Listed	October 9th, 2025
Days on Market	3
Zoning	Residential
HOA Fees	\$400
HOA Fees Freq.	Semi-Annually
Property Taxes	\$2,352
Tax Year	2024
Office	Boise Premier Real Estate
Contact Info	brett@boisepremier.com

Listing Details

Listing Office	Boise Premier Real Estate
----------------	---------------------------



IDX information is provided exclusively for consumers' personal, non-commercial use, and may not be used for any purpose other than to identify prospective properties consumers may be interested in purchasing. IMLS does not assume any liability for missing or inaccurate data. Information provided by IMLS is deemed reliable but not guaranteed.

Listing information last updated on October 12th, 2025 at 12:48am MDT