

\$383,000 - 18446 N Sparkleberry Ave, Nampa

MLS® #98963858

\$383,000

3 Bedroom, 2.00 Bathroom, 1,217 sqft
Residential on 0.17 Acres

Sweetwater Glen, Nampa, ID

Welcome to the American Dream Series, with Lennar's signature "Everything's Included", featuring refrigerator, washer/dryer, window blinds, and full landscaping! Your kitchen features stainless steel appliances. Quartz countertops and backsplashes complement the white Shaker-style cabinetry, Luxury vinyl plank flooring, and chrome faucets in the in the kitchen and bathrooms. Other features, like the garage keypad, full aluminum gutters, tankless water heater, and more, make this home reliable and beautiful! Sweetwater Glen features green spaces with walking paths, a Tot Lot, a Club House, and community pool! Just minutes to the freeway, shopping, and dining!

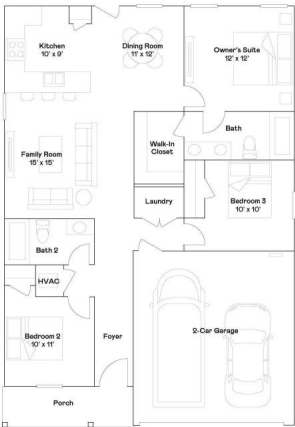

Built in 2026

Essential Information

MLS® #	98963858
Price Per SQFT	\$315
Bedrooms	3
Bathrooms	2.00
Square Footage	1,217
Acres	0.17
Year Built	2026
Type	Residential
Sub-Type	Single Family Residence
Status	Active

Community Information

Address	18446 N Sparkleberry Ave
Area	Caldwell NW - 1275
Subdivision	Sweetwater Glen
City	Nampa
County	Canyon
State	ID
Zip Code	83687
Builder	Lennar

Amenities

Utilities	Sewer Connected
Parking Spaces	2
Parking	Attached
# of Garages	2
Golf Course	N

Interior

Appliances	ENERGY STAR Qualified Water Heater
Heating	Forced Air
Cooling	Central Air
Stories	One
Primary On Main	Yes

Exterior

Lot Description	Standard Lot 6000-9999 SF, Auto Sprinkler System, Full Sprinkler System, Pressurized Irrigation Sprinkler System
Roof	Composition, Architectural Style

School Information

District	Vallivue School District #139
Elementary	East Canyon
Middle	Sage Valley
High	Ridgevue

Additional Information

Date Listed	October 3rd, 2025
Days on Market	4
HOA Fees	\$230
HOA Fees Freq.	Quarterly

New Construction Yes
Tax Year 2024
Office Fathom Realty
Contact Info kim@idaholifehomes.com

Listing Details

Listing Office Fathom Realty



IDX information is provided exclusively for consumers' personal, non-commercial use, and may not be used for any purpose other than to identify prospective properties consumers may be interested in purchasing. IMLS does not assume any liability for missing or inaccurate data. Information provided by IMLS is deemed reliable but not guaranteed.

Listing information last updated on October 15th, 2025 at 2:18am MDT