

\$1,225,000 - 1141 E Crowne Pointe Drive, Eagle

MLS® #98963660

\$1,225,000

4 Bedroom, 4.00 Bathroom, 4,536 sqft

Residential on 0.30 Acres

Rivers End, Eagle, ID

Found 3-5 minutes to downtown Eagle, this one of a kind home is found in the boutique community of Rivers End nestled among mature landscape and ponds with views. This community enjoys its own, private greenbelt access, community pool, clubhouse, many serene ponds and picturesque waterfalls. Come home to 4500+ sf of spacious living with its secluded, unbelievable 19x16 main level primary suite with access to its own separate, private patio and 18' walk-in closet. Upper level boasts 3 extra-large bedrooms, each with walk-in closets, 2 full baths-a dual access bathroom, plus another full bath. The impressive 20x18 bonus room AND 22x13 theater room provides space for everyone to do everything for play and privacy. Enjoy all the main level has to offer with the open kitchen, casual breakfast dining area, and great room designed to accommodate any size gathering or event. The main level formal living and dining rooms offer even mores to have fun with family and friends. A soaring 15'+ entry, private office and generous 3 car garage complete this well-built, unique home. Come see where enjoying a morning coffee or evening sunsets on the additional patio overlooking the pond is the best place to begin or end your every day.

Built in 2005

Essential Information

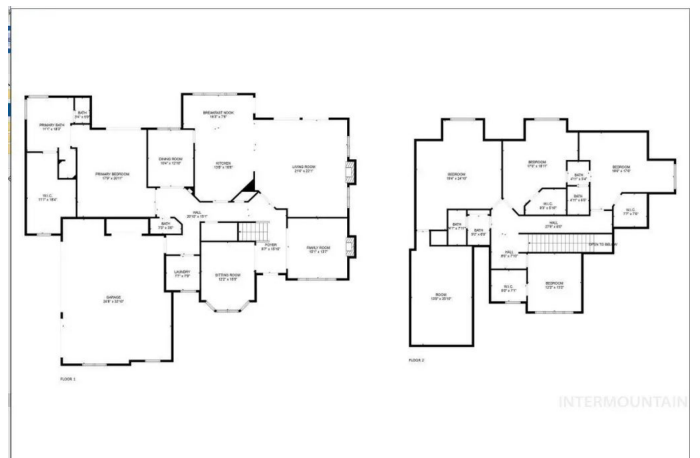

MLS® #	98963660
Price Per SQFT	\$270
Bedrooms	4
Bathrooms	4.00
Square Footage	4,536
Acres	0.30
Year Built	2005
Type	Residential
Sub-Type	Single Family Residence
Status	Active

Community Information

Address	1141 E Crowne Pointe Drive
Area	Eagle - 0900
Subdivision	Rivers End
City	Eagle
County	Ada
State	ID
Zip Code	83616

Amenities

Utilities	Sewer Connected
Parking Spaces	3
Parking	Attached
# of Garages	3
Has Pool	Yes
Pool	Community, In Ground, Pool
Golf Course	N

Interior

Interior Features	Bath-Master, Bed-Master Main Level, Guest Room, Split Bedroom, Den/Office, Formal Dining, Family Room, Great Room, Rec/Bonus, Double Vanity, Central Vacuum Plumbed, Walk-In Closet(s), Breakfast Bar, Kitchen Island, Granite Counters, Tile Counters
Appliances	Gas Water Heater, Tank Water Heater, Dishwasher, Disposal, Microwave, Oven/Range Built-In, Refrigerator, Washer, Dryer
Heating	Forced Air, Natural Gas
Cooling	Central Air
Fireplace	Yes

Fireplaces	Two, Gas
Stories	Two
Primary On Main	Yes

Exterior

Lot Description	10000 SF - .49 AC, Irrigation Available, Sidewalks, Corner Lot, Auto Sprinkler System, Full Sprinkler System
Roof	Composition

School Information

District	West Ada School District
Elementary	Andrus
Middle	Eagle Middle
High	Eagle

Additional Information

Date Listed	October 2nd, 2025
Days on Market	3
HOA Fees	\$650
HOA Fees Freq.	Quarterly
Property Taxes	\$4,158
Tax Year	2024
Office	Silvercreek Realty Group
Contact Info	broker@silvercreekrealty.com

Listing Details

Listing Office	Silvercreek Realty Group
----------------	--------------------------



IDX information is provided exclusively for consumers' personal, non-commercial use, and may not be used for any purpose other than to identify prospective properties consumers may be interested in purchasing. IMLS does not assume any liability for missing or inaccurate data. Information provided by IMLS is deemed reliable but not guaranteed.

Listing information last updated on October 12th, 2025 at 11:48am MDT