

\$3,599,900 - 6190 W Lily Creek Ln, Nampa

MLS® #98960800

\$3,599,900

7 Bedroom, 6.00 Bathroom, 6,208 sqft
Residential on 5.06 Acres

0 Not Applicable, Nampa, ID

Morgan Creek Homes invites you to discover exclusive 5-acre country estates in Calla Lily Creek – an opportunity unlike anything else in the Treasure Valley. Why wait for the Parade of Homes when you can create something even greater? Envision a custom retreat with a stunning glass view wine room fully enclosed and ready to showcase, while the entertainment room transforms into the ultimate hosting space with an upscale bar or curated coffee bar – perfect for movie nights or intimate gatherings. Step outside to your private resort with a pool designed for relaxation and entrainment. Inside, flexibility abounds; convert a bedroom into a state-of-the-art gym, add a dedicated high-tech indoor golf simulator wing, or enjoy a spa retreat where every night feels like an escape. Every detail invites you to live, host, and unwind at a level that defines true luxury. This home is a fully customizable build – dimensions, finishes, and designing may all be tailored to your wants and needs.

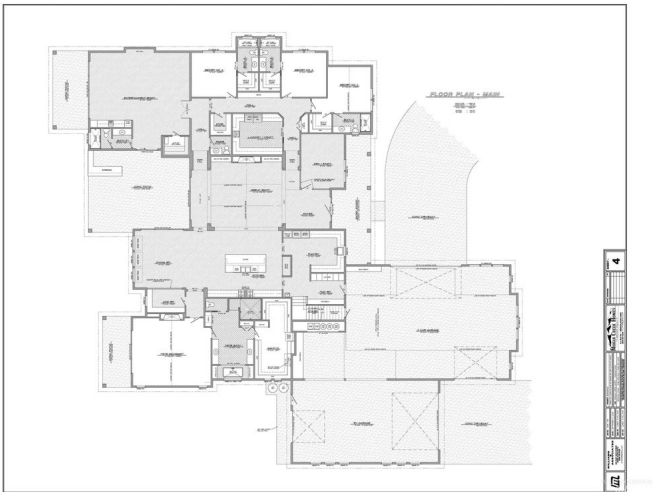

Built in 2026

Essential Information

MLS® #	98960800
Price Per SQFT	\$580
Bedrooms	7
Bathrooms	6.00
Square Footage	6,208

Acres	5.06
Year Built	2026
Type	Residential
Sub-Type	Single Family w/ Acreage
Status	Active

Community Information

Address	6190 W Lily Creek Ln
Area	Meridian SW - 1010
Subdivision	0 Not Applicable
City	Nampa
County	Ada
State	ID
Zip Code	83687
Builder	Morgan Creek Homes

Amenities

Utilities	Electricity Connected
Parking Spaces	7
Parking	Attached, RV Access/Parking
# of Garages	7
Has Pool	Yes
Pool	In Ground, Pool
RV/Boat Parking	Yes
Horses	Yes
Gated	Yes
Golf Course	N

Interior

Interior Features	Bath-Master, Bed-Master Main Level, Great Room, Sauna/Steam Room, Rec/Bonus, Double Vanity, Walk-In Closet(s), Breakfast Bar, Pantry, Kitchen Island, Quartz Counters
Appliances	Dishwasher, Disposal, Double Oven, Oven/Range Built-In, Refrigerator, Gas Range
Heating	Forced Air
Cooling	Central Air
Fireplace	Yes
Fireplaces	One, Gas
Stories	Single w/ Upstairs Bonus Room

Primary On Main Yes

Exterior

Lot Description 5 - 9.9 Acres, Garden, Horses, R.V. Parking, Chickens, Auto Sprinkler System, Pressurized Irrigation Sprinkler System

Foundation Slab

School Information

District West Ada School District

Elementary Mary McPherson

Middle Victory

High Meridian

Additional Information

Date Listed September 6th, 2025

Days on Market 11

HOA Fees \$250

HOA Fees Freq. Quarterly

New Construction Yes

Tax Year 2024

Structures Shop, Barn(s)

Office Silvercreek Realty Group

Contact Info broker@silvercreekrealty.com

Listing Details

Listing Office Silvercreek Realty Group



IDX information is provided exclusively for consumers' personal, non-commercial use, and may not be used for any purpose other than to identify prospective properties consumers may be interested in purchasing. IMLS does not assume any liability for missing or inaccurate data. Information provided by IMLS is deemed reliable but not guaranteed.

Listing information last updated on October 11th, 2025 at 7:33pm MDT