

\$825,000 - 703 S Phillippi St, Boise

MLS® #98956973

\$825,000

6 Bedroom, 6.00 Bathroom, 4,546 sqft

Residential Income on 0.22 Acres

Charles Wolfe, Boise, ID

Excellent central Boise Bench opportunity for multi-generational living, house hack, or investment. Currently set up as 5 rented units. Month to month tenants in 2 of the units. 3 units vacant. Property was once used as an assisted living/residential care facility/group home. Fire sprinkler system and alarm system are present, but have not been serviced since 2017. Possibility to convert back to care facility. Extensive updates have been done on exterior and interior. Newer roof (2019), 3 HVAC systems all recently serviced. Close to everything: minutes to downtown, Garden City and the greenbelt, highway access, St Al's and other medical facilities, shopping and dining. No photos of basement due to being tenant occupied. Will consider owner carry.

Built in 1978

Essential Information

MLS® #	98956973
Price Per SQFT	\$181
Bedrooms	6
Bathrooms	6.00
Square Footage	4,546
Acres	0.22
Year Built	1978
Type	Residential Income
Sub-Type	Other
Status	Active

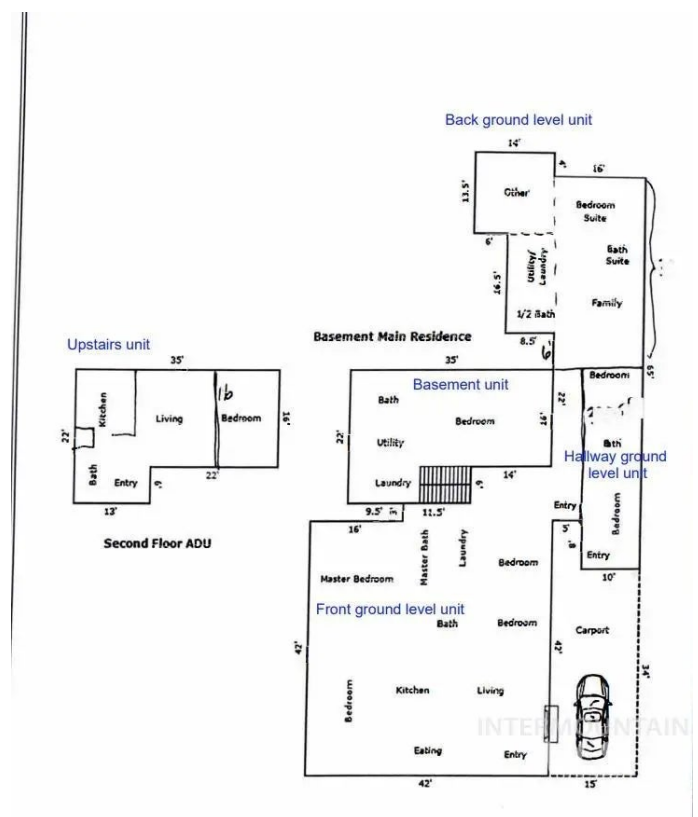

Community Information

Address	703 S Phillippi St
Area	Boise Bench - 0400
Subdivision	Charles Wolfe
City	Boise
County	Ada
State	ID
Zip Code	83705

Amenities

Utilities	Sewer Connected, Cable Connected
Parking Spaces	4
Parking	Finished Driveway
Golf Course	N

Interior

Appliances	Disposal (Some Units), Stove/Range (Some Units), Refrigerator (All Units), Washer/Dryer (All Units)
Heating	Forced Air, Natural Gas, Fireplace(s)
Cooling	Central Air
Fireplace	Yes

Exterior

Lot Description	Standard Lot 6000-9999 SF, Garden
Roof	Composition

School Information

District	Boise School District #1
Elementary	Hillcrest
Middle	South Boise Jr
High	Borah

Additional Information

Date Listed	August 4th, 2025
Days on Market	67
Property Taxes	\$4,456
Tax Year	2024
Office	Silvercreek Realty Group
Contact Info	broker@silvercreekrealty.com

Listing Details

Listing Office

Silvercreek Realty Group



IDX information is provided exclusively for consumers' personal, non-commercial use, and may not be used for any purpose other than to identify prospective properties consumers may be interested in purchasing. IMLS does not assume any liability for missing or inaccurate data. Information provided by IMLS is deemed reliable but not guaranteed.

Listing information last updated on October 11th, 2025 at 8:48pm MDT