

# \$777,000 - 10210 W Hackamore Dr, Boise

MLS® #98956451

**\$777,000**

4 Bedroom, 3.00 Bathroom, 2,432 sqft  
Residential on 0.91 Acres

Country Estates, Boise, ID

4-3-2-1! Spacious and inviting, this 2,400 sq ft, 4 bedroom, 3 bathroom home with a 2-car garage sits on almost 1 acre in a highly desirable neighborhood. Possibilities are endless--the city allows an ADU up to 900 sq ft, a pool, a shop, or even keep animals--choose your opportunity to customize your property. Outbuilding is 24x12 and attached cover 12x8 with power. Could be used for animals or for DIY shop. Designed for multi-generational living, this well-maintained home has been lovingly cared for and comes with a full inspection already completed for peace of mind. The layout offers flexibility, comfort, and plenty of room for everyone. Enjoy the great community, the space of a large lot, and the freedom to make it your own. Pride of ownership shines throughout this home. This property is ready for you to move in and start creating your Idaho dream lifestyle!

Built in 1973

## Essential Information

MLS® #	98956451
Price Per SQFT	\$319
Bedrooms	4
Bathrooms	3.00
Square Footage	2,432
Acres	0.91
Year Built	1973
Type	Residential

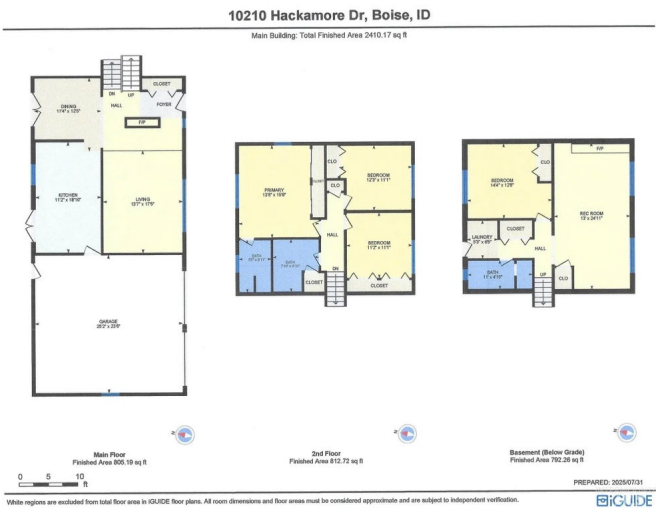



Sub-Type	Single Family Residence
Status	Active

### Community Information

Address	10210 W Hackamore Dr
Area	Boise SW-Meridian - 0550
Subdivision	Country Estates
City	Boise
County	Ada
State	ID
Zip Code	83709

### Amenities

Utilities	Electricity Connected
Parking Spaces	2
Parking	Attached, Tandem, RV Access/Parking, Finished Driveway
# of Garages	2
Waterfront	Irrigation Canal/Ditch
RV/Boat Parking	Yes
Golf Course	N
Virtual Tour	<a href="https://360idaho.tf.media/x2420892">https://360idaho.tf.media/x2420892</a>

### Interior

Interior Features	Bath-Master, Formal Dining, Family Room, Great Room, Kitchen Island, Granite Counters, Tile Counters
Appliances	Gas Water Heater, Dishwasher, Double Oven, Refrigerator, Gas Range
Heating	Natural Gas
Cooling	Central Air
Fireplace	Yes
Fireplaces	Gas, Insert
Stories	Tri-Level

### Exterior

Lot Description	1/2 - .99 AC, Garden, Irrigation Available, R.V. Parking, Auto Sprinkler System, Full Sprinkler System, Irrigation Sprinkler System
Roof	Composition, Architectural Style
Foundation	Crawl Space

### School Information



District	Boise School District #1
Elementary	Horizon Boise
Middle	West Boise Jr
High	Borah

**Additional Information**

Date Listed	July 31st, 2025
Days on Market	75
Property Taxes	\$4,001
Tax Year	2024
Structures	Shop, Storage Shed
Office	Skyline Realty
Contact Info	broker@skylineboiserealestate.com

**Listing Details**

Listing Office	Skyline Realty
----------------	----------------



IDX information is provided exclusively for consumers' personal, non-commercial use, and may not be used for any purpose other than to identify prospective properties consumers may be interested in purchasing. IMLS does not assume any liability for missing or inaccurate data. Information provided by IMLS is deemed reliable but not guaranteed.

Listing information last updated on October 14th, 2025 at 11:48pm MDT