

\$0 - 14058 Hipwell Drive, Nampa

MLS® #98955801

\$0

4 Bedroom, 4.00 Bathroom, 3,458 sqft

Residential on 1.98 Acres

Hipwell Estates, Nampa, ID

Discover luxury country living on nearly 2 acres just south of Lake Lowell. This thoughtfully designed single-story home features 4 spacious bedrooms, 3.5 bathrooms, a large bonus room, and an impressive 52â€™™ RV bay in addition to the 3-car garageâ€™™perfect for all your toys and storage needs. Enjoy elevated living with built-in Thermador appliances, two dishwashers, a prep kitchen, and designer finishes throughout. Expansive windows frame scenic views of Lake Lowell, offering the peace of rural living just minutes from Nampaâ€™™s conveniences.

Built in 2026

Essential Information

MLS® #	98955801
Bedrooms	4
Bathrooms	4.00
Square Footage	3,458
Acres	1.98
Year Built	2026
Type	Residential
Sub-Type	Single Family w/ Acreage
Status	No Price New Construction

Community Information

Address	14058 Hipwell Drive
Area	Nampa South (86) - 1260



INTERMOUNTAIN

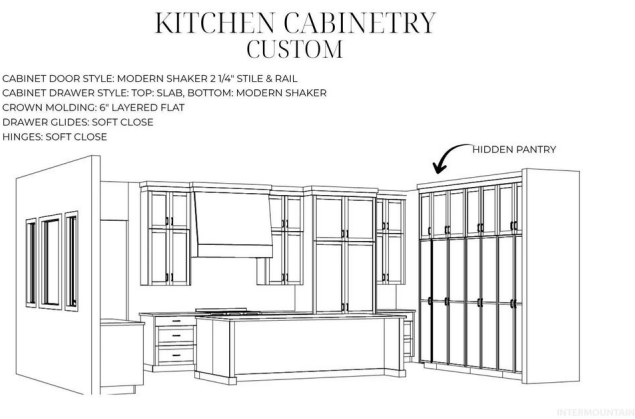

Subdivision	Hipwell Estates
City	Nampa
County	Canyon
State	ID
Zip Code	83686

Amenities

Parking Spaces	5
# of Garages	5
Golf Course	N

Interior

Stories	One
Primary On Main	Yes

Exterior

Lot Description	1 - 4.99 AC
Foundation	Crawl Space

School Information

District	Vallivue School District #139
Elementary	West Canyon
Middle	Vallivue Middle
High	Vallivue

Additional Information

Date Listed	July 24th, 2025
HOA Fees	\$500
HOA Fees Freq.	Annually
New Construction	Yes
Property Taxes	\$1,227
Tax Year	2024
Office	Homes of Idaho
Contact Info	info@homesofidaho.com

Listing Details

Listing Office	Homes of Idaho
----------------	----------------



IDX information is provided exclusively for consumers' personal, non-commercial use, and may not be used for any purpose other than to identify prospective properties consumers may be interested in

purchasing. IMLS does not assume any liability for missing or inaccurate data. Information provided by IMLS is deemed reliable but not guaranteed.

Listing information last updated on October 12th, 2025 at 6:48am MDT