

# \$324,900 - 315 N 9th Ave North, Payette

MLS® #98951233

**\$324,900**

2 Bedroom, 3.00 Bathroom, 1,395 sqft  
Residential Income on 0.04 Acres

Jordans Landin, Payette, ID

Proudly present Jordan Landing. Brand-new 41unit townhome community in Payette, Idaho. Created for those seeking a refined and low-maintenance lifestyle, these stunning 2bedroom, 2.5bath single level townhomes feature spacious main-level living, a gourmet kitchen, and high-end upgrades typically found in luxury homes. Thoughtfully designed with wider hallways and doorways, each home offers enhanced accessibility for wheelchair users. The open-concept living area flows seamlessly into a chef-inspired kitchen complete with an island, pantry, and all major appliances. Exterior maintenance is handled by the HOA, allowing residents to enjoy a nearly maintenance-free lifestyle. The community will include a park and outdoor dining areas with grills, perfect for gathering with friends and neighbors. Jordan Landing is located in an Opportunity Zone, offering investors a chance to buy and hold properties for 7-10 years to potentially shelter capital gains.

Built in 2025

## Essential Information

MLS® #	98951233
Price Per SQFT	\$233
Bedrooms	2
Bathrooms	3.00
Square Footage	1,395

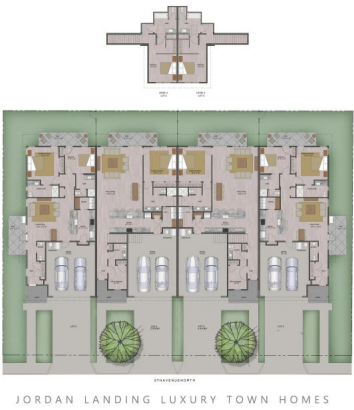

Acres	0.04
Year Built	2025
Type	Residential Income
Sub-Type	Other
Status	Active

### Community Information

Address	315 N 9th Ave North
Area	Payette - 1750
Subdivision	Jordans Landin
City	Payette
County	Payette
State	ID
Zip Code	83661

### Amenities

Utilities	Sewer Connected
Parking Spaces	2
Parking	Two Car, Attached, RV Access/Parking, Finished Driveway
# of Garages	2
RV/Boat Parking	Yes
Golf Course	N

### Interior

Appliances	Disposal (All Units), Stove/Range (All Units), Refrigerator (All Units), Washer/Dryer (No Units)
Heating	Forced Air, Natural Gas
Cooling	Central Air

### Exterior

Lot Description	Small Lot 5999 SF, R.V. Parking, Sidewalks
Roof	Composition
Foundation	Crawl Space

### School Information

District	Payette School District #371
Elementary	Payette
Middle	McCain
High	Payette

## Additional Information

Date Listed	June 16th, 2025
Days on Market	76
HOA Fees	\$200
HOA Fees Freq.	Annually
Property Taxes	\$20
Tax Year	2025
Office	Stevens Realty
Contact Info	barbarastevens1@gmail.com

## Listing Details

Listing Office	Stevens Realty
----------------	----------------



IDX information is provided exclusively for consumers' personal, non-commercial use, and may not be used for any purpose other than to identify prospective properties consumers may be interested in purchasing. IMLS does not assume any liability for missing or inaccurate data. Information provided by IMLS is deemed reliable but not guaranteed.

Listing information last updated on October 14th, 2025 at 5:48pm MDT