

# \$0 - Tbd W Grover St, Boise

MLS® #98938491

**\$0**

4 Bedroom, 3.00 Bathroom, 2,373 sqft  
Residential on 0.19 Acres

Simunich/Mike S, Boise, ID

Modern new construction with a 3 car garage with a 40' deep tandem bay, perfect for storing all of your Idaho toys, or offering an ideal shop space, an unheard of amenity to new construction in urban Boise. No HOA/CCRs in this quiet pocket of the Bench, conveniently located near shopping & restaurants. Sitting on a private lot, backing to the canal with mature shade trees lining the backyard, offering a peaceful respite to enjoy under the covered patio. Attention to detail exudes throughout the design & floorplan with a great room layout & kitchen with stainless appliances, pantry & a chef's designed functionality. The primary suite features dual vanities, designer tilework & walk-in closet, plus an ensuite guest room on the main level and bonus room offering a versatile layout for every lifestyle. This hidden gem is being constructed by highly reputable, long time local builder, Kouba Homes. Property is located behind the existing home at 5610 W Grover, in the Northwest corner bordering the canal.

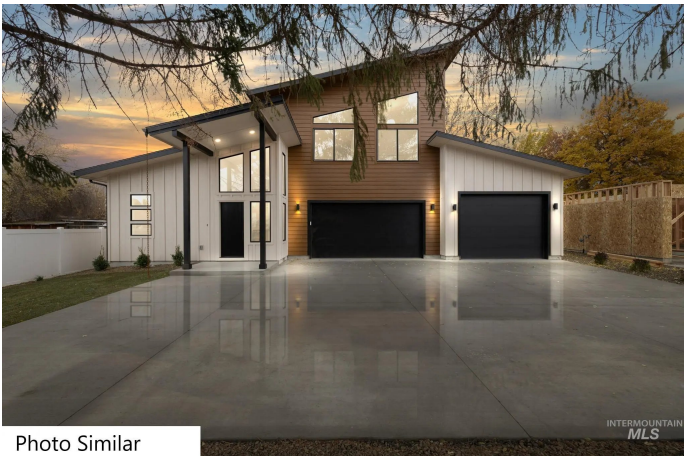
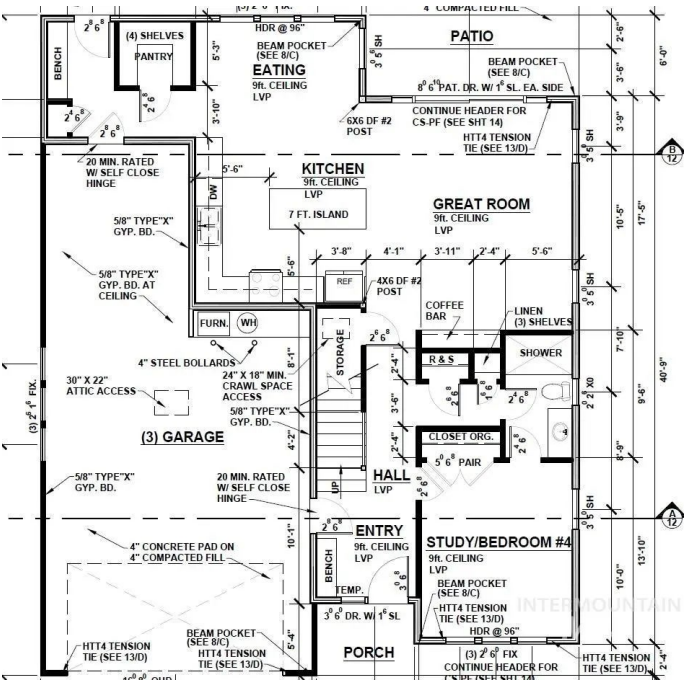

Photo Similar



Built in 2025

## Essential Information

MLS® #	98938491
Bedrooms	4
Bathrooms	3.00
Square Footage	2,373
Acres	0.19

Year Built	2025
Type	Residential
Sub-Type	Single Family Residence
Status	No Price New Construction

### Community Information

Address	Tbd W Grover St
Area	Boise Bench - 0400
Subdivision	Simunich/Mike S
City	Boise
County	Ada
State	ID
Zip Code	83705
Builder	Kouba Homes

### Amenities

Utilities	Sewer Connected
Parking Spaces	3
Parking	Attached, Electric Vehicle Charging Station(s)
# of Garages	3
Is Waterfront	Yes
Waterfront	Waterfront
Golf Course	N

### Interior

Interior Features	Bath-Master, Great Room, Rec/Bonus, Double Vanity, Walk-In Closet(s), Pantry, Kitchen Island, Quartz Counters
Appliances	Tank Water Heater, Dishwasher, Disposal, Oven/Range Built-In, Gas Range
Heating	Forced Air, Natural Gas
Cooling	Central Air
Stories	Two

### Exterior

Lot Description	Standard Lot 6000-9999 SF, Garden, Auto Sprinkler System, Full Sprinkler System
Roof	Architectural Style

### School Information

District	Boise School District #1
----------	--------------------------

Elementary

Hillcrest

Middle

South (Boise)

High

Borah

Additional Information

Date Listed

March 10th, 2025

Zoning

R-1C

New Construction

Yes

Tax Year

2024

Office

RE/MAX Capital City

Contact Info

bmayesreo@msn.com

Listing Details

Listing Office

RE/MAX Capital City



IDX information is provided exclusively for consumers' personal, non-commercial use, and may not be used for any purpose other than to identify prospective properties consumers may be interested in purchasing. IMLS does not assume any liability for missing or inaccurate data. Information provided by IMLS is deemed reliable but not guaranteed.

Listing information last updated on October 14th, 2025 at 4:48pm MDT

